

## Bumper Pull Horse Trailer Model 9652



### TRAILER HIGHLIGHTS

- **Durable all-aluminum construction**
- **Straight load 2-horse trailer with 2' shortwall**
- **Rear ramp standard**
- **3/4" rubber floor mats in horse area**
- **7' straight load divider with shoulder separator & back leg on removable post**
- **Aerodynamic v-nose with camper door**
- **Standard aluminum wheels**
- **10+3 warranty\*: 10 years structural & 3 years bumper-to-bumper**

Even more value awaits horse owners with Featherlite's Model 9652 straight load bumper pull horse trailer. It features a rear ramp, aluminum butt/chest bars with padding and aluminum wheels standard. This newly enhanced design for Featherlite straight loads includes a 7' straight load divider with shoulder separator and back leg on a removable post along with a camper door in the trailer's v-nose.

### PRODUCT SPECIFICATIONS

- Trailer width of 6'7"
- Length of 12'6"
- 7'6" inside height
- 38" stall width
- 54" full width rear ramp with double doors above & pipe hardware
- .040 white aluminum lining floor to ceiling
- Two outside tie rings & 2 inside tie rings per horse
- White .040 aluminum exterior sheets
- Tandem 3500# axles with 15" aluminum wheels with Rainier tires

## Bumper Pull Horse Trailer Model 9652

FEATURE	FUNCTION	BENEFIT
<b>All-Aluminum Construction</b>	Featherlites are made with an all-aluminum frame and skin.	With just routine maintenance, aluminum construction has higher resistance to rust and corrosion and in the long run, they hold their value longer. It's also lighter weight, increasing your payload capacity and making for a smoother tow.
<b>Uni-Body Design</b>	All components of the Featherlite trailer from side posts to roof rails to roof bows to cross members are engineered into a uni-body design.	The uni-body design makes the trailer stronger and more durable for the long haul.
<b>White Lining</b>	White lining on walls above rubber & up to ceiling standard.	White lining creates a brighter interior for horses during loading & travel, keeping them calmer. It also gives the trailer a cleaner, more eye-appealing interior.
<b>3/4" Rubber Floor Mats</b>	3/4" rubber floor mats are standard in the horse area.	The thickness of Featherlite's floor mats give horses the greatest amount of comfort and stability during travel, reducing stress and potential injury to the horse.
<b>Aerodynamic Nose</b>	Featherlite bumper pulls feature standard aerodynamic noses.	Better aerodynamics during hauling creates a smoother tow.

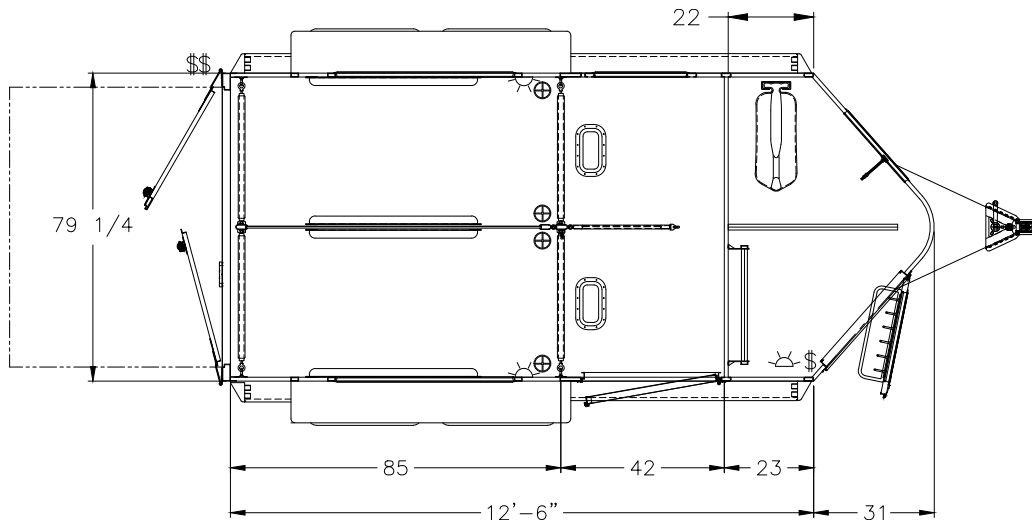

**For full array of floorplans, visit [www.fthr.com](http://www.fthr.com)**

\*10-year limited structural warranty on frame and superstructure. 3-year limited warranty on all other parts manufactured and installed by Featherlite. Some exclusions apply. See website or dealer for details. Trailer may be shown with options.